

BROWNE

- NOTES:**
- 1. All signs and cones to be in accordance with Chapter 8-2009, the TSRGD and current IAN's.
  - 2.Works access and egress are indicative, exact locations to be agreed on site.
  - 3.Safety zones are to be installed as required.
  - 4. All signs to be located so as not to obscure signs or objects and should be ballasted near to ground level using sand filled hessian bags or sign straps.
  - 5. All sign positions are indicative only and must be accurately positioned on site with good visibility and be clear of and obstructions or vegetation at all times.
  - 6. Drawing not to scale
  - 7.TM will comply with the Safety at Street Works and Road Works Code of Practice

Qty: 1 Ref: 13-9-RCAG Road Closed Access Only	
Qty: 2 Ref: 13-9 Schedule 13-9 - Temporary Information	
Qty: 4 Ref: 13-9 Schedule 13-9 - Temporary Information	
Qty: 4 Ref: 13-9 Schedule 13-9 - Temporary Information	
Qty: 2 Ref: 13-9 Schedule 13-9 - Temporary Information	
Qty: 2 Ref: 2702 End of temporary diversion route	
Qty: 2 Ref: 2702 Start of temporary diversion route	
Qty: 2 Ref: 2702 Start of temporary diversion route	
Qty: 3 Ref: 2702 Start of temporary diversion route	
Qty: 3 Ref: 2703 Direction of temporary diversion route from junction ahead	
Qty: 3 Ref: 2703 Direction of temporary diversion route from junction ahead	
Qty: 46 Ref: 2703 Direction of temporary diversion route from junction ahead	
Qty: 3 Ref: 2704 Direction of temporary diversion route	
Qty: 3 Ref: 2704 Direction of temporary diversion route	
Qty: 1 Ref: 573 Direction to hazard right	
Qty: 1 Ref: 573 Direction to hazard left	
Qty: 3 Ref: 7010-FP-13-9 Nature of temporary hazard ahead - Road Closed	
Qty: 3 Ref: 7010-FP-13-9 Nature of temporary hazard ahead - Road Ahead Closed	
Qty: 2 Ref: 7010-1 Nature of temporary hazard ahead - Road Ahead Closed	

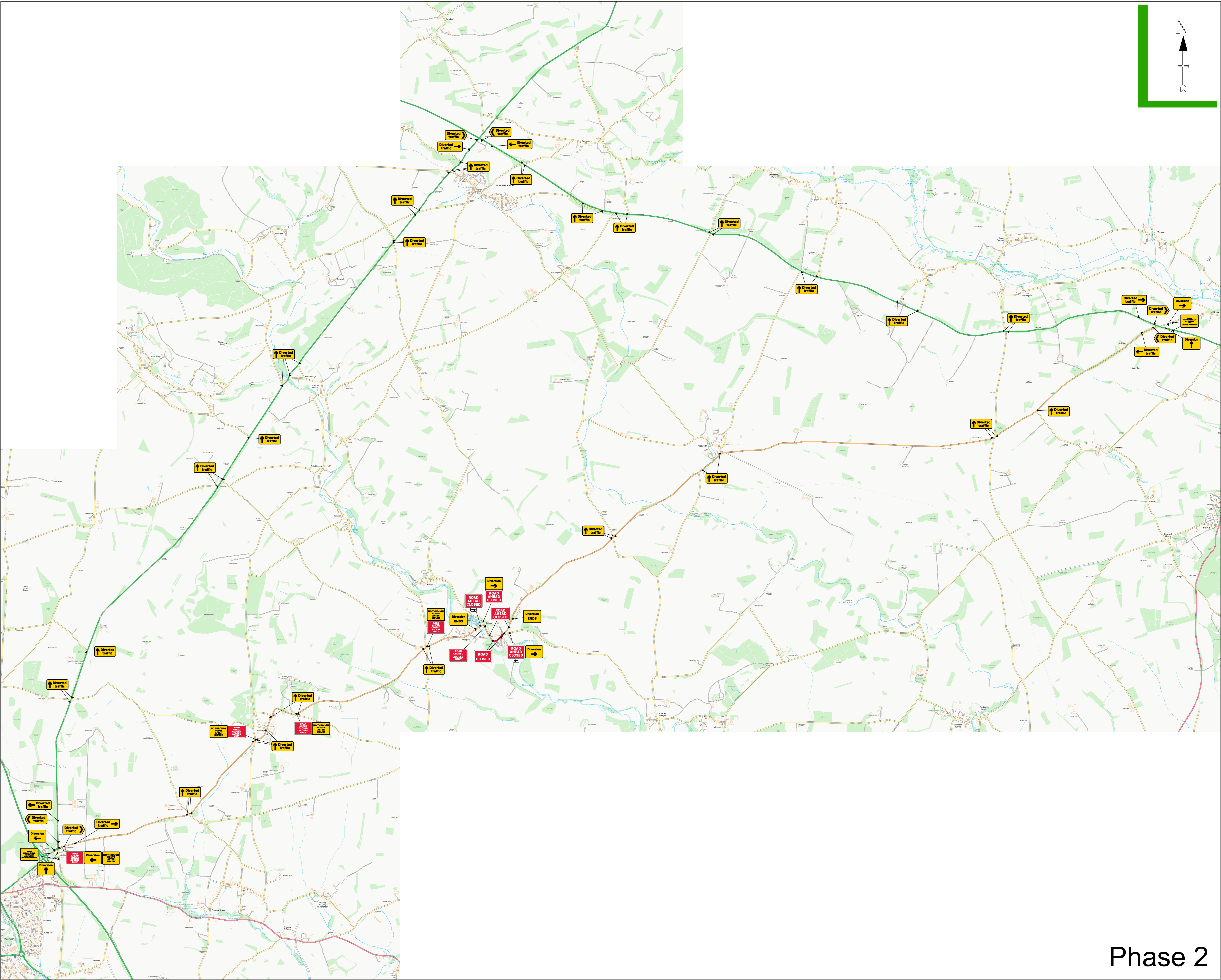

<b>KEY:</b>			
	SAFETY ZONE		CONE
	WORK AREA		PED BARRIER
	SPOIL AREA		NO PARKING CONE
			Bus stop suspension
			Parking Bay suspension

DETAILS OF THE ROAD	
	B4425

Drawn By	M Oprescu	Traffic Management	Road Closure
Checked By	M Tataru	Road Name	B4425
Survey By	Client	Borough/Council	Gloucestershire County
Date Drawn	15/04/2025	Postcode	GL7 5NS
Drawing No	K9791		



- NOTES:
1. All signs and cones to be in accordance with Chapter 8-2009, the TSRGD and current IAN's.
  - 2.Works access and egress are indicative, exact locations to be agreed on site.
  - 3.Safety zones are to be installed as required.
  4. All signs to be located so as not to obscure signs or objects and should be ballasted near to ground level using sand filled hessian bags or sign straps.
  5. All sign positions are indicative only and must be accurately positioned on site with good visibility and be clear of and obstructions or vegetation at all times.
  6. Drawing not to scale
  - 7.TM will comply with the Safety at Street Works and Road Works Code of Practice

Qty: 1 Ref: 2702 Start of temporary diversion route	
Qty: 1 Ref: 2702 Start of temporary diversion route	
Qty: 2 Ref: 517 Road narrows on one side only ahead - left	
Qty: 2 Ref: 517 Road narrows on one side only ahead - right	
Qty: 1 Ref: 573 Direction to hazard right	
Qty: 1 Ref: 573 Direction to hazard left	
Qty: 2 Ref: 610 Keep right	
Qty: 1 Ref: 610 Keep left	
Qty: 1 Ref: 612 No right turn	
Qty: 1 Ref: 613 No left turn	
Qty: 4 Ref: 645 End panel	
Qty: 8 Ref: 7001 Road works ahead	
Qty: 2 Ref: 7010-FP-13-9 Nature of temporary hazard ahead - Road Ahead Closed	
Qty: 2 Ref: 7010-FP-13-9 Nature of temporary hazard ahead - Road Closed	
Qty: 2 Ref: 7010-1 Nature of temporary hazard ahead - Road Ahead Closed	
Qty: 1 Ref: 7105 Lane closure barrier	

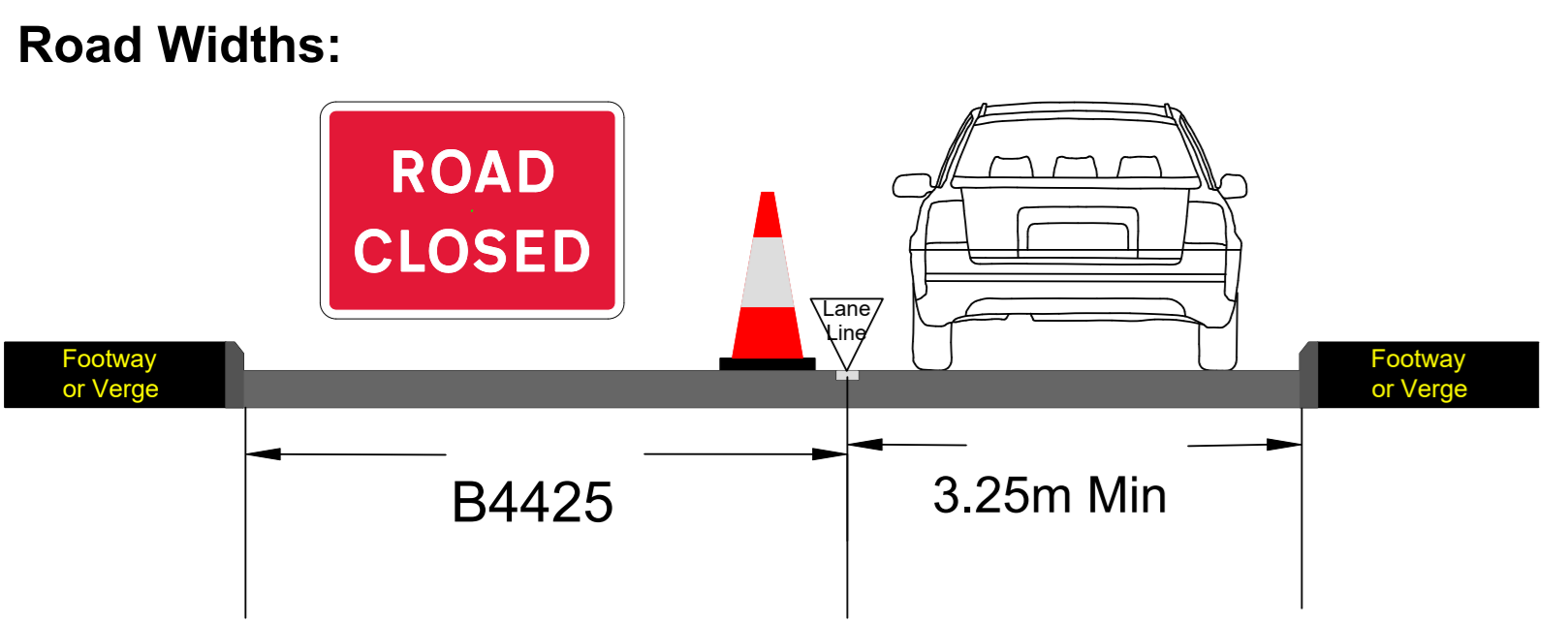

## Diversion as per Phase 2.

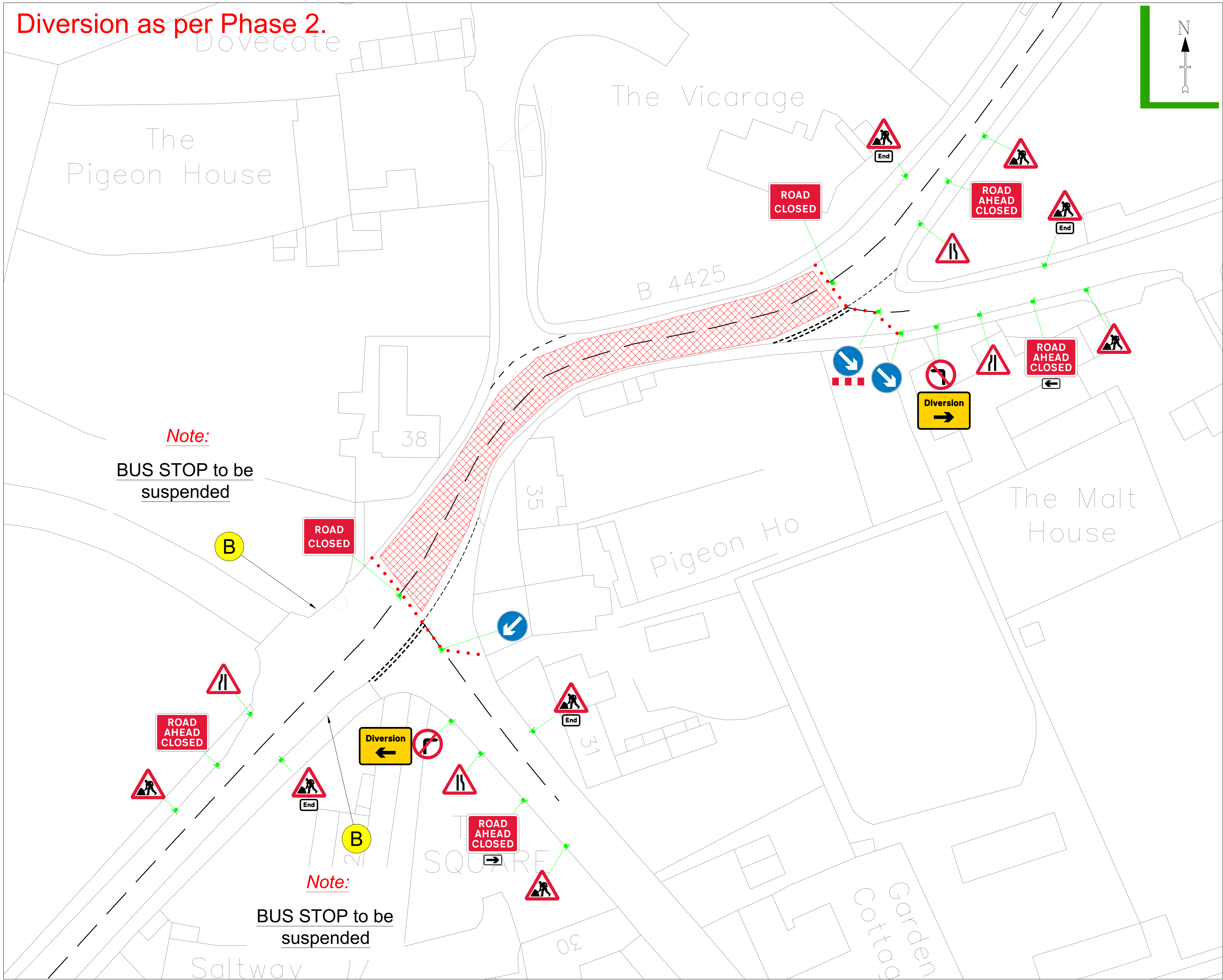

<b>KEY:</b>		<b>DETAILS OF THE ROAD</b>		Drawn By		Traffic Management		Road Closure	
	SAFETY ZONE		CONE		Bus stop suspension		R Asauanu		B4425
	WORK AREA		PED BARRIER		Parking Bay suspension		Client		Gloucestershire County
	SPOIL AREA		NO PARKING CONE				10/06/2025		GL7 5NS
							K10101		

**BROWNE**

**NOTES:**

1. All signs and cones to be in accordance with Chapter 8-2009, the TSRGD and current IAN's.
2. Works access and egress are indicative, exact locations to be agreed on site.
3. Safety zones are to be installed as required.
4. All signs to be located so as not to obscure signs or objects and should be ballasted near to ground level using sand filled hessian bags or sign straps.
5. All sign positions are indicative only and must be accurately positioned on site with good visibility and be clear of and obstructions or vegetation at all times.
6. Drawing not to scale
7. TM will comply with the Safety at Street Works and Road Works Code of Practice

Qty: 1 Ref: 2702 Start of temporary diversion route	
Qty: 1 Ref: 517 Road narrows on one side only ahead - right	
Qty: 2 Ref: 517 Road narrows on one side only ahead - left	
Qty: 1 Ref: 573 Direction to hazard left	
Qty: 2 Ref: 610 Keep right	
Qty: 1 Ref: 610 Keep left	
Qty: 1 Ref: 613 No left turn	
Qty: 4 Ref: 645 End panel	
Qty: 7 Ref: 7001 Road works ahead	
Qty: 2 Ref: 7010-FP-13-9 Nature of temporary hazard ahead - Road Ahead Closed	
Qty: 2 Ref: 7010-FP-13-9 Nature of temporary hazard ahead - Road Closed	
Qty: 1 Ref: 7010.1 Nature of temporary hazard ahead - Road Ahead Closed	
Qty: 1 Ref: 7105 Lane closure barrier	

**Road Widths:**

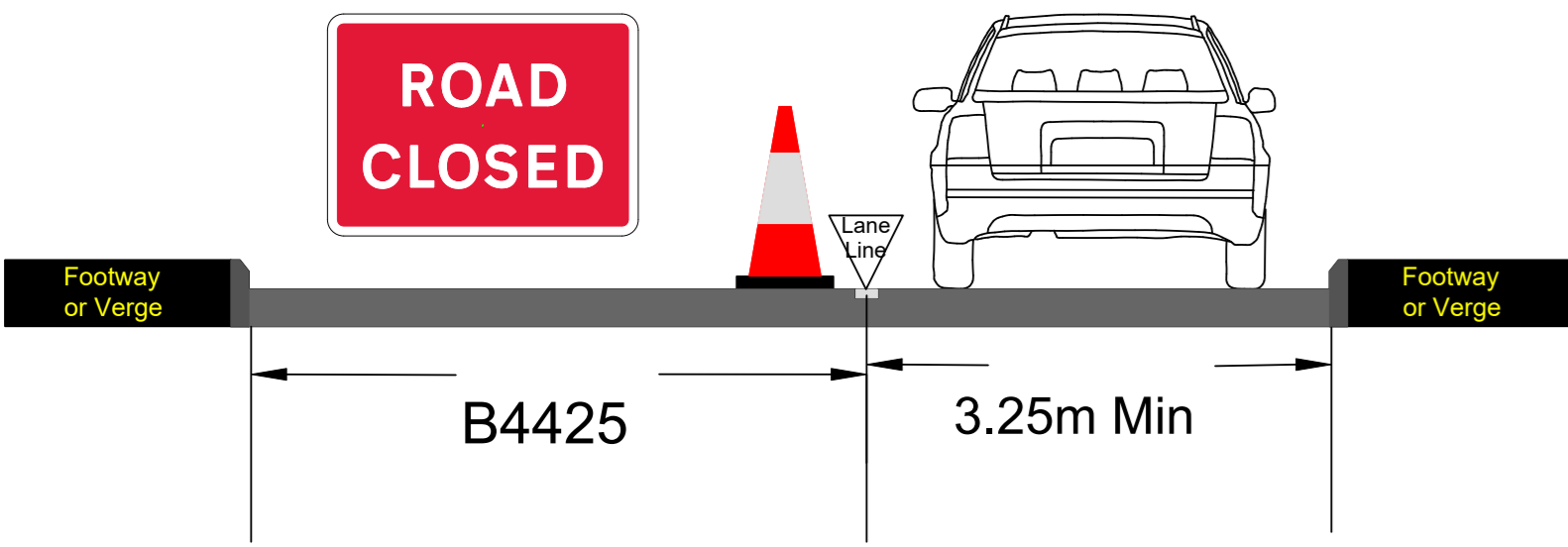

**Diversion as per Phase 2.**

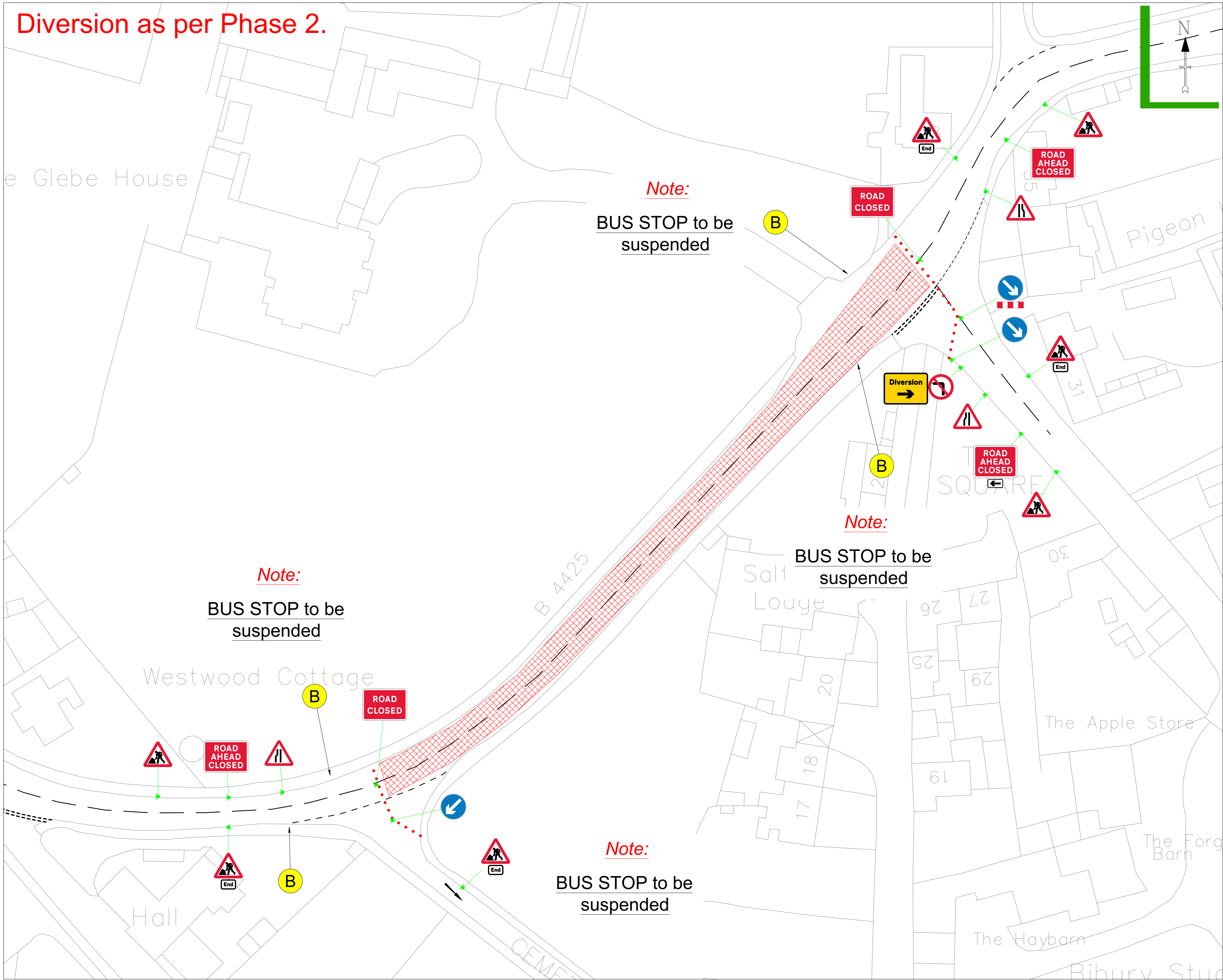









<b>KEY:</b>			
	SAFETY ZONE		CONE
	WORK AREA		PED BARRIER
	SPOIL AREA		NO PARKING CONE
			Bus stop suspension
			Parking Bay suspension

DETAILS OF THE ROAD
B4425

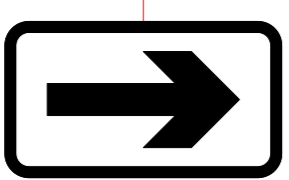
Drawn By	M Oprescu	Traffic Management	Road Closure
Checked By	R Asauanu	Road Name	B4425
Survey By	Client	Borough/Council	Gloucestershire County
Date Drawn	10/06/2025	Postcode	GL7 5NS
Drawing No	K10101		

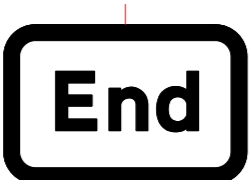
BROWNE





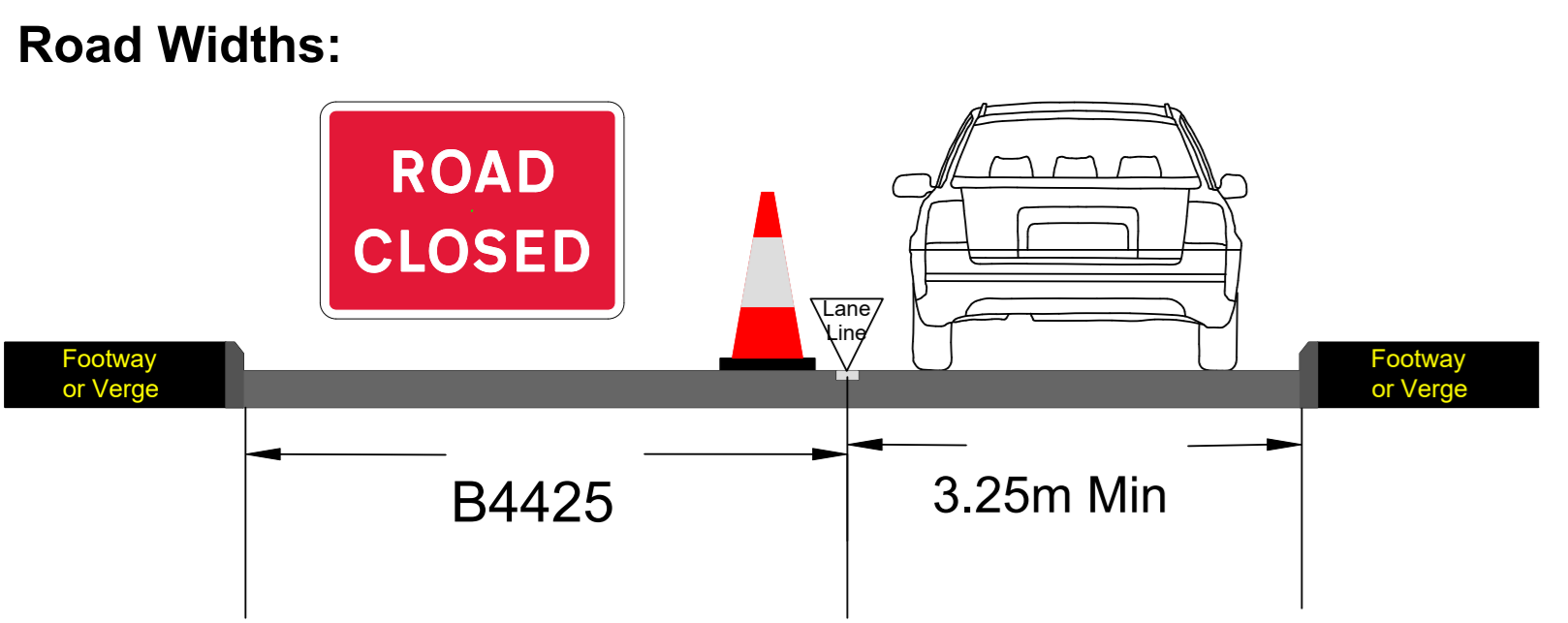

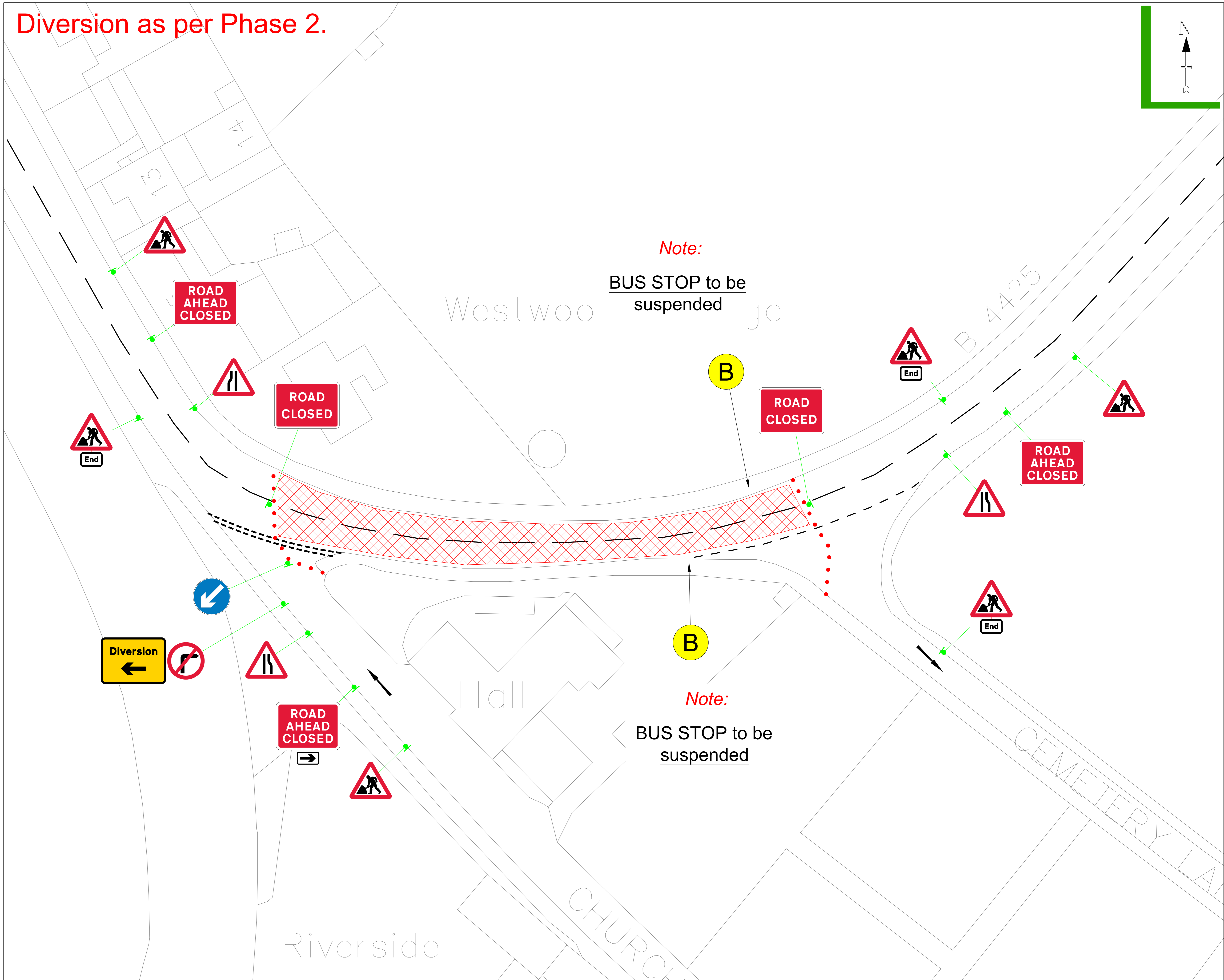

- NOTES:**
1. All signs and cones to be in accordance with Chapter 8-2009, the TSRGD and current IAN's.
  2. Works access and egress are indicative, exact locations to be agreed on site.
  3. Safety zones are to be installed as required.
  4. All signs to be located so as not to obscure signs or objects and should be ballasted near to ground level using sand filled hessian bags or sign straps.
  5. All sign positions are indicative only and must be accurately positioned on site with good visibility and be clear of and obstructions or vegetation at all times.
  6. Drawing not to scale
  7. TM will comply with the Safety at Street Works and Road Works Code of Practice

Qty: 1    Ref: 2702 Start of temporary diversion route	
Qty: 1    Ref: 517 Road narrows on one side only ahead - left	
Qty: 2    Ref: 517 Road narrows on one side only ahead - right	
Qty: 1    Ref: 573 Direction to hazard right	
Qty: 1    Ref: 610 Keep left	
Qty: 1    Ref: 612 No right turn	
Qty: 3    Ref: 645 End panel	
Qty: 6    Ref: 7001 Road works ahead	
Qty: 2    Ref: 7010-FP-13-9 Nature of temporary hazard ahead - Road Ahead Closed	
Qty: 2    Ref: 7010-FP-13-9 Nature of temporary hazard ahead - Road Closed	
Qty: 1    Ref: 7010.1 Nature of temporary hazard ahead - Road Ahead Closed	



Diversion as per Phase 2.



<b>KEY:</b>				
	SAFETY ZONE		CONE	 Bus stop suspension
	WORK AREA		PED BARRIER	 Parking Bay suspension
	SPOIL AREA		NO PARKING CONE	

DETAILS OF THE ROAD	
	B4425

Drawn By	M Oprescu	Traffic Management	Road Closure
Checked By	R Asauanu	Road Name	B4425
Survey By	Client	Borough/Council	Gloucestershire County
Date Drawn	10/06/2025	Postcode	GL7 5NS
Drawing No	K10101		