



Heating your homes from Mogden Sewage Treatment Works

What work are you doing?

We're working with our partners in the gas industry (SGN Commercial Services) to install a biomethane upgrade unit at Mogden Sewage Treatment Works.

Installing this new technology means we can give back to our communities by using the leftover gas from our sewage treatment process to heat local homes with renewable energy. It will also be a big help in our plans to become a carbon negative business by 2040 with the first milestone: net zero 2030.

The installation will involve some minor work in a small area of the site. We'll then export this gas into the local gas distribution system. In order to do this we'll be building a new 1km biomethane export pipeline from our Waste Water Treatment site on Mogden Lane to the local natural gas distribution system on Chertsey Road



An example of the biomethane unit to be installed

What is biomethane and how is it used?

When we treat your wastewater we separate the solids from the liquids and treat them in digesters to break them down. This treatment process creates sustainable biogas.

Typically, this biogas is made up of methane, carbon dioxide (CO₂) and other left over gases. We already use the biogas we create to help us generate power for the site and some local homes. However, if we have more gas than we can turn into energy we need to burn it on site.

The new biomethane unit will allow us to treat the biogas so it's clean enough to put directly into the gas network – helping us heat local homes with renewable methane.



An example of the inside of the unit.

Why are you doing the work?

We've been producing our own renewable power since the 1930s. However, to help protect the environment for future generations, we need to completely transform the way we create and use energy. This upgrade project is the first of many similar projects at our sites to help us do just that.

The Mogden biomethane unit is expected to help us reduce our carbon emissions by over 8 kilotons of CO₂ per year. That's about 3% of our 2022/23 net carbon deficit and will play a huge part in helping us reach our net zero carbon target by 2030.

The unit will also help us improve our environmental impact by significantly improving air quality around the site and reducing the need to burn excess gas.

We hope to install similar units to some of our other sites in the future to give back to our communities and potentially help us power our site vehicles.

How will it work?

Biogas produced on site will be split between the existing gas engine and our new biomethane unit.

The new unit will process up to 1150 m³ of biogas an hour, removing the carbon dioxide and some other natural impurities, to produce around 700 m³ of biomethane an hour. That's enough to heat around 3,500 homes.

Once the gas is cleaned, we'll add the standard methane gas smell. This is what's done in the national gas network to keep everyone safe by making it easier to identify gas leaks.

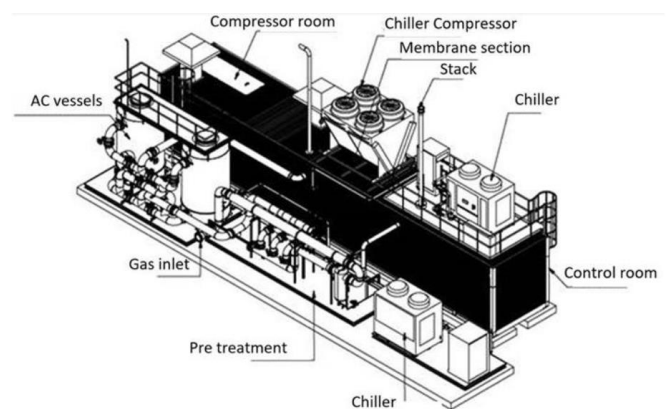

An example of the biomethane unit to be installed

Where are you working?

The biomethane unit will be installed on our site at Mogden Lane.

The export pipeline will run from the site to Cherstey Road where it will connect into the gas grid. You can find a map of the pipeline route within this information pack, along with some plans of how traffic may be managed along key parts of the route during the work.

A key assumption is that works will not take place during any period where there is a major rugby event at Twickenham Stadium. As a result of this it is highly likely that the majority of the works will take place in the summer and early autumn of 2022 in order to achieve our desired completion dates in the Spring of 2023.

Where we'll be working



The blue line shows the route of the pipeline

Traffic Management Plans

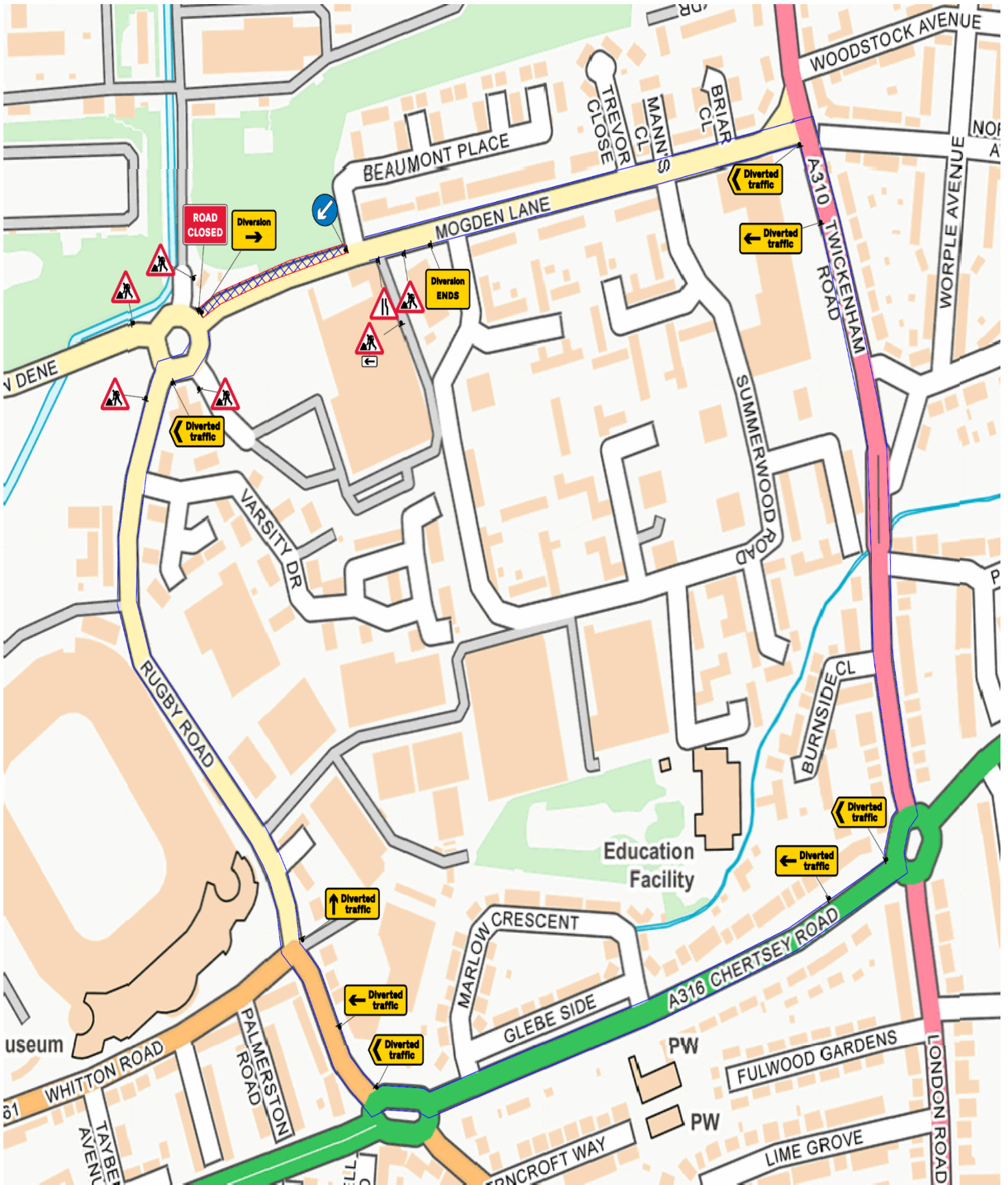

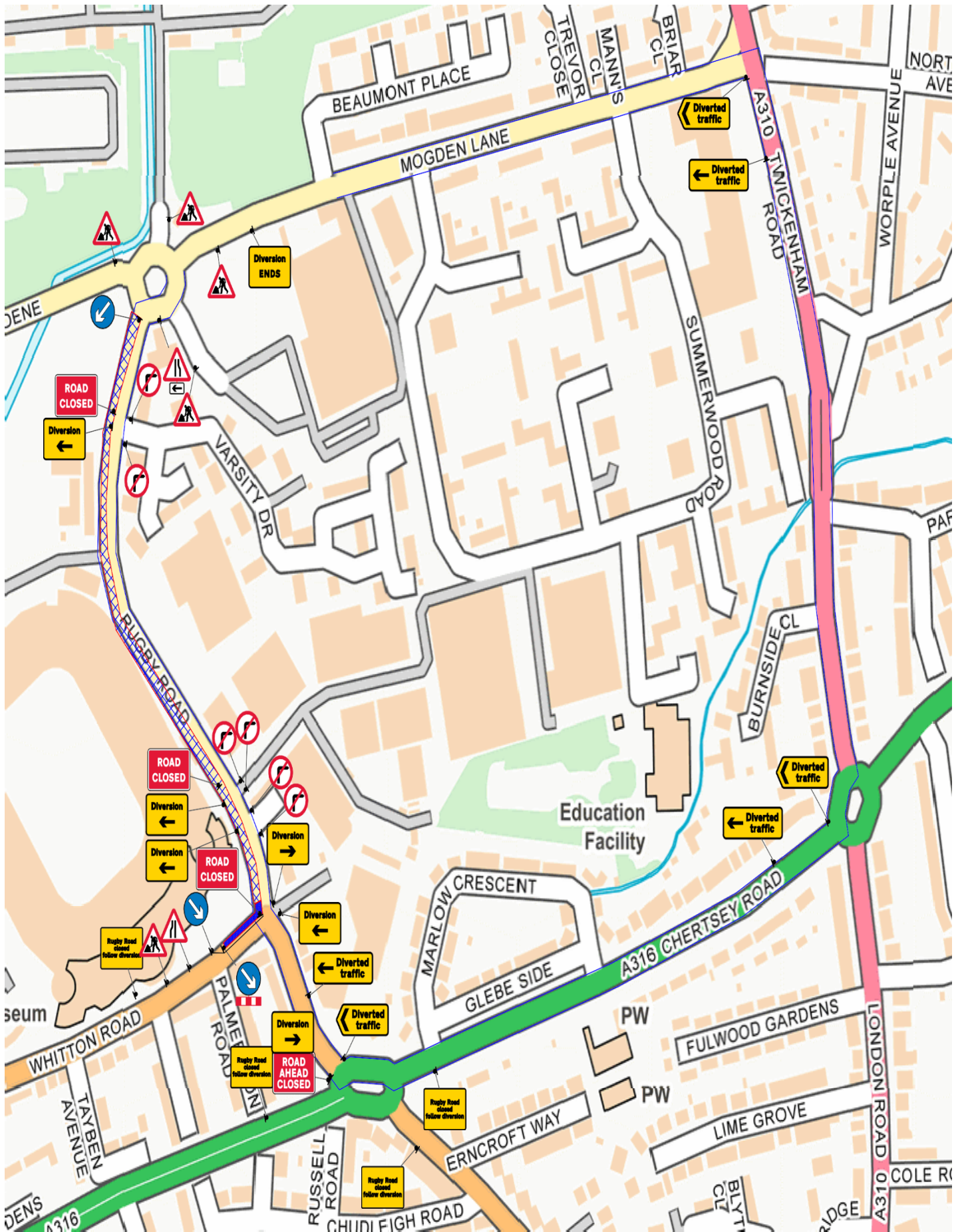

When are you working?

Our work to install the pipeline will start 15 August 2022 and completed Spring 2023

Our usual working hours will be Monday to Friday 8am to 5pm. If required, weekend working hours will be Saturday 9am to 4pm and Sunday 9am to 1pm

If there are any changes to these working hours or if we need to do one-off out of hours work for any reason, we'll get in touch in advance to let you know the details.

How we'll be doing the works

The biomethane upgrader plant will be built within the Mogden Waste Water Site. We'll be using traditional open cut methods, mainly in the carriageway of existing public roads to fit the export pipeline.

Will this work impact my service from you?

No, our site will continue to function as usual, and we'll work around existing processes on site to provide your wastewater services as normal.

Can I find out more?

You can find all the information about our work on our website at:

thameswater.co.uk/mogdengastogrid

If there are any changes to the information in this pack, we'll write to you to let you know.

If you have any questions about our work and can't find the information on our website, you can reach us using the contact details below.

Here to help

We help thousands of people every year through our priority services. If you or someone you know could use a little extra support, we're here to take care of you, too.

Whether you're in later life, living with a medical condition or experiencing a change in your personal circumstances, we'll be on hand in case your water stops flowing. And if you have specific communication needs, we can help with that too.

To sign up for our priority services or to find out more, just visit

thameswater.co.uk/priorityservices

Get in touch

Find out more on our website:

thameswater.co.uk/mogdengastogrid

Call us and quote reference
number:154088
0800 316 9800



Frequently Asked Questions

How long will the project take?

We're planning to start works in Summer 2022 till Spring 2023, with the majority of the works taking place in the summer and early autumn of 2022 to avoid any conflict with events at Twickenham Stadium.

Will there be road closures?

Yes, there will be lane closures and/or traffic lights. We'll be giving residents plenty of notice of our traffic management plans before starting works.

Will there be access to my driveway?

Yes, there will be times when we'll need to block your drive. We'll endeavour to maintain access by using road plating where possible. We'll give you notice so you can plan your access.

Will there be increased noise?

Yes, there will be noise but only during working hours. We'll minimise noise as much as possible.

Will water or gas supply be affected?

Existing gas and water supplies will not be affected by the works.

Will refuse collections still happen?

During our work, pedestrians and emergency vehicles will have access to all roads. Bin collections will continue as normal.

I'm worried this will affect my business

We'll do all we can to minimise disruption to residents and businesses while we work, but sometimes businesses are affected. If this happens, help is on hand at thameswater.co.uk/lossofprofits