

SEWER LAYOUT RELATIVE TO EXISTING BUILDING

SEWER LAYOUT RELATIVE TO NEW EXTENSION



Any existing manholes or chambers on the public sewer cannot be retained within new buildings please relocate outside of the new building where feasible.

TYPICAL MANHOLE DETAIL TYPE C
DEPTH FROM COVER LEVEL TO SOFFIT OF PIPE LESS THAN 1.5M
MAX. PIPE SIZE = 450MM DIA.

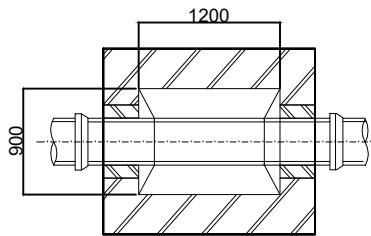
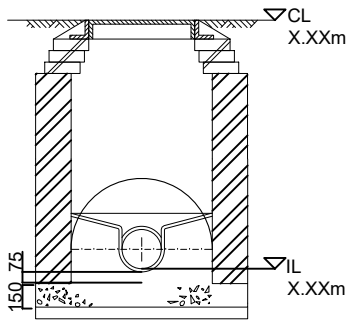

PIPE SURROUND AND BRIDGING DETAIL

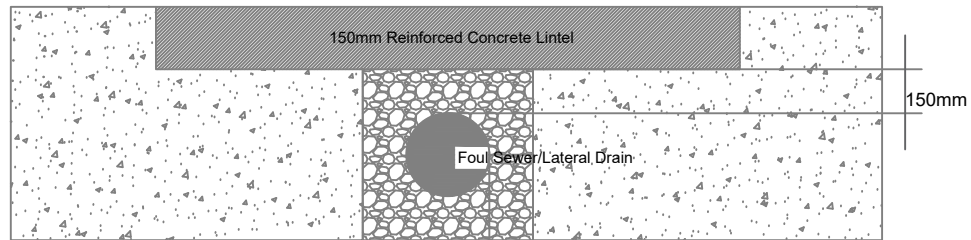

Pipe to be surrounded with pea-gravel or as per Thames Water requirements

DO NOT SCALE

THE POSITION OF THE APPARATUS SHOWN ON THIS PLAN IS GIVEN WITHOUT OBLIGATION AND WARRANTY AND THE ACCURACY CANNOT BE GUARANTEED. SERVICE PIPES ARE NOT SHOWN BUT THEIR PRESENCE SHOULD BE ANTICIPATED. NO LIABILITY OF ANY KIND WHATSOEVER IS ACCEPTED BY THAMES WATER FOR ANY ERROR OR OMISSION. THE ACTUAL POSITION OF MAINS AND SERVICES MUST BE VERIFIED ON SITE BEFORE ANY WORKS ARE UNDERTAKEN.

THE DATA PROVIDED IS RELEVANT ONLY TO THE CURRENT PROJECT. ENQUIRY AND SHOULD NOT BE USED FOR ANY OTHER PURPOSES.

Notes:

1. New IC will comply with BS EN 771-1 using Class B engineering bricks in accordance with Figure B 14 (Type C) of the Design and Construction Guidance (DCG) within the Code for Adoptions, selected using Access Type Selection on Figure 3 with BS EN 124 cover (un-trafficked area).
2. All bricks will have freeze/thaw designation F2.
3. Unused inlets will be sealed and watertight to avoid groundwater ingress.
4. New pipe bedding to comply with IGN 4-08-01.
5. The pipe will be replaced, if required, with like for like material, believed to be VC 100mm diameter.
6. This drawing is not to be used for construction.
7. This is not a design drawing. The principal designer will remain responsible for all designer duties specified within CDM2015.
8. The location of all utilities must be located on site prior to works commencing.
9. The Client must inform the contractors of any hazards on site.

- Foul sewer —
- Surface Water sewer —
- Boundary —
- Proposed Extension —
- Foul Inspection Chamber •

ISS	Description	Dsgnt	Chkd	Appd	Date

Thames Water Utilities
DEVELOPER SERVICES
CUSTOMER EXPERIENCE,
CLEARWATER COURT,
VASTERN ROAD,
READING RG1 8DB
TEL: 0800 059 3921

EMAIL: DEVELOPER.SERVICES@THAMESWATER.CO.UK

ISSUE DATE: March 23 REVIEW DATE: SECURITY REF: NA DRAWN BY: DR

PROJECT GROUP: Service Delivery

DATA OWNER: Thames Water

DRAWING TITLE: Example Build Over Sewer Drawing

DRAWING No: B0001_Rev SCALE: NTS SHEET SIZE: A1