

Site Address:
 Newbury Road
 Eastbury
 RG17 7JN
 TW2526.ENAB.MOB







Client:
 CPH Contact:
 tmdrawings@theclancygroup.co.uk

Date of works:
 T.B.A

Drawn by: BH
 Date drawn: 09/04/2026

Drawing Requested By:
 Suchet Gill

KEY

-  Diversion Route
-  Sign
-  Works Area
-  Diversion Symbol

Diversion:

newbury road
 newbury street
 high street
 hungerford hill
 ermin street
 hungerford hill
 newbury road
 church street
 newbury road

and reverse

Drawing Number:
 BH/7277MOD3

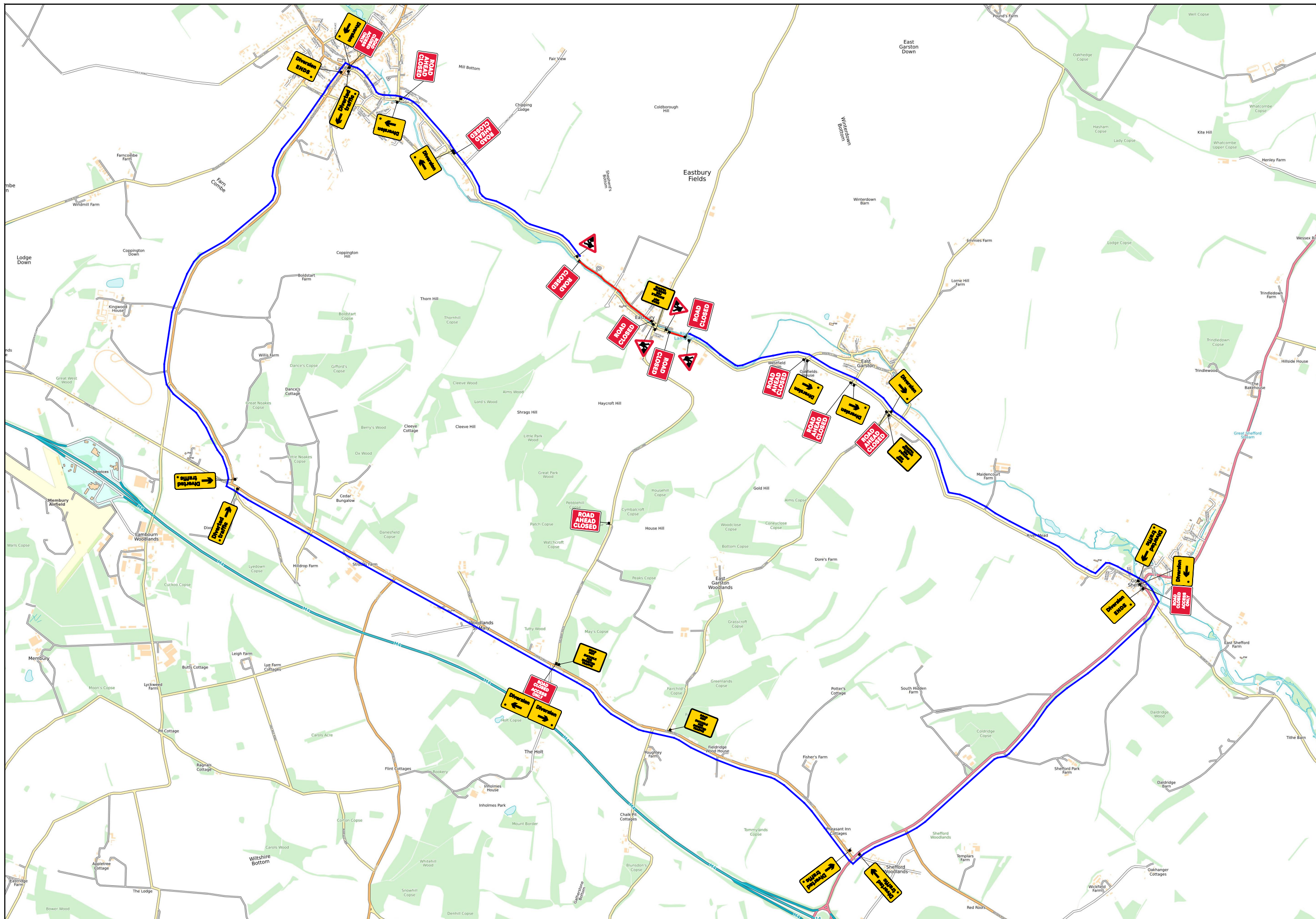

NOTES

- 1) All temporary traffic management shall be in accordance with Chapter 8 Part 1 Design (2009): Part 2 Operations (2009): Part 3 Update (2020).
- 2) All temporary traffic management shall be in accordance with the Traffic Signs Regulations and General Directions 2016.
- 3) All temporary traffic management shall conform to the Safety at Streetworks and Road Works ACOP 2013.
- 4) All temporary traffic management signs should be located 450mm minimum from the kerb face.
- 5) All temporary traffic management sign locations are indicative and are subject to on site approval from the supervisor.

100METER ROLLING ROAD CLOSURE
 + DIVERSION
 PHASE 3

SET-UP TO BE IN ACCORDANCE WITH THE NRSWA SAFETY AT STREET WORKS CODE



Clare House,
 Coppermill Ln,
 Harefield,
 Middlesex, UB9 6HZ
 Tel: 01895 823711
 Email:
 tmdrawings@theclancygroup.co.uk