

**KEY**

- Traffic Barrier
- Traffic Cones
- Traffic Sign Direction
- Vehicle Signal Head
- Ped Barriers
- Works Area
- Safety Zone

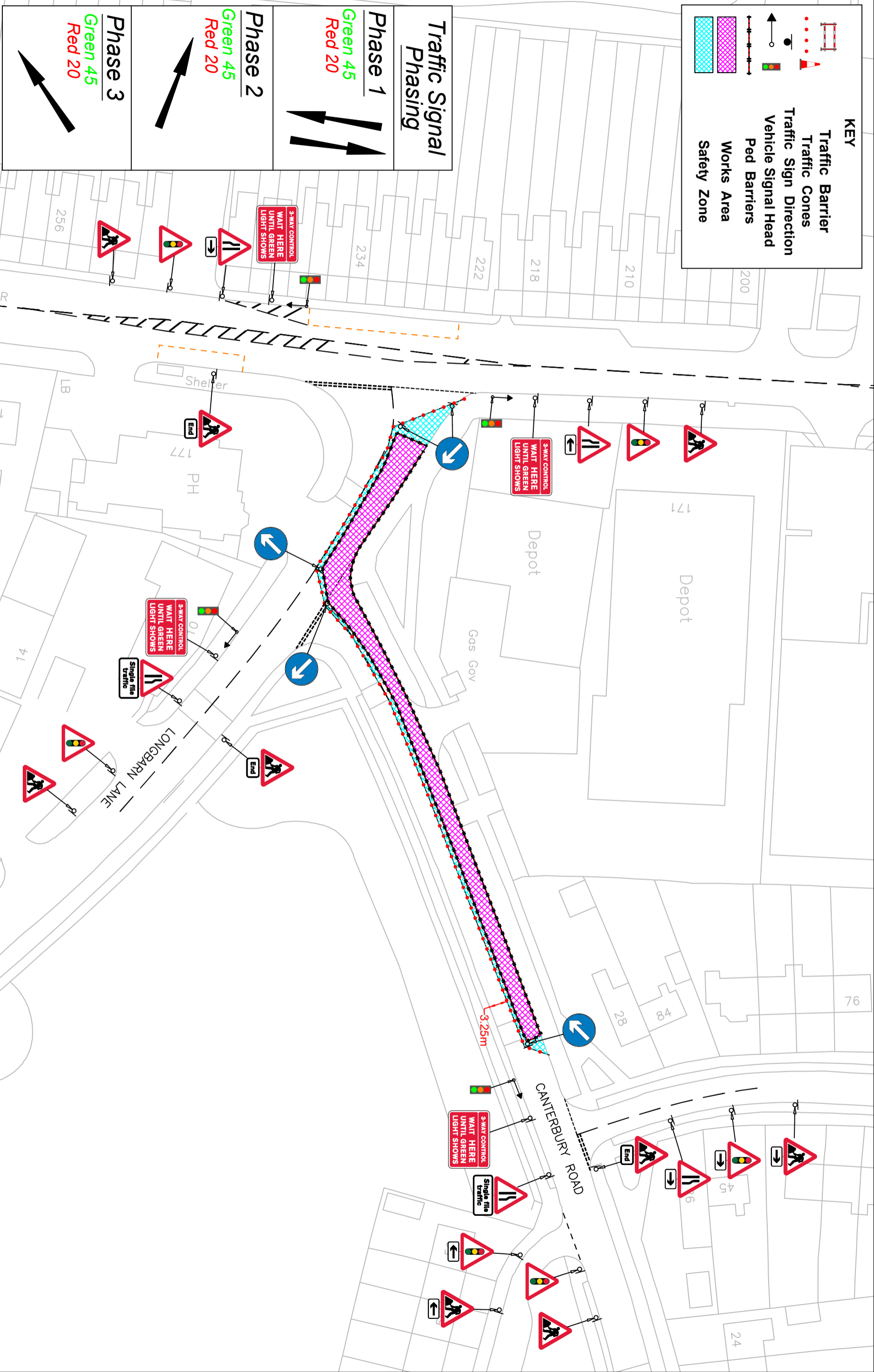

**Traffic Signal Phasing**

**Phase 1**  
Green 45  
Red 20

**Phase 2**  
Green 45  
Red 20

**Phase 3**  
Green 45  
Red 20

BASINSTOKE ROAD  
READING,  
RG2 0HA

Units 3, 4 & 5 River Moles Business Park  
Mill Mead Road, Esher,  
Surrey KT10 8BJ  
Tel: 0800 6444 114  
Web: www.tglogroup.co.uk  
Email: tmdrawings@tglogroup.co.uk

- 1) TEMPORARY TRAFFIC MANAGEMENT TO BE SET OUT IN ACCORDANCE WITH CHAPTER 8 AND SAFE WORKING PRACTICES.
- 2) ALL BUS, PARKING AND LOADING BAYS SHOULD BE SUSPENDED WITH THE RELEVANT AUTHORITY PRIOR TO COMMENCEMENT OF WORK.
- 3) WORKS VEHICLES TO BE PARKED WITHIN WORKS AREA.

DATE DRAWN 25/02/26  
DRAWN BY TGL DDC  
CHECKED BY TGL CJ  
SCALE N.T.S.

Drawing No. 1215.04-18