

BROWNE

- NOTES:**
1. All signs and cones to be in accordance with Chapter 8-2009, the TSRGD and current IAN's.
 - 2.Works access and egress are indicative, exact locations to be agreed on site.
 - 3.Safety zones are to be installed as required.
 4. All signs to be located so as not to obscure signs or objects and should be ballasted near to ground level using sand filled hessian bags or sign straps.
 5. All sign positions are indicative only and must be accurately positioned on site with good visibility and be clear of and obstructions or vegetation at all times.
 6. Drawing not to scale
 - 7.TM will comply with the Safety at Street Works and Road Works Code of Practice

Qty: 2 Ref: 13-9-RCAG Road Closed Access Only	
Qty: 2 Ref: 13-9 Schedule 13-9: Temporary Information	
Qty: 2 Ref: 13-9 Schedule 13-9: Temporary Information	
Qty: 4 Ref: 13-9 Schedule 13-9: Temporary Information	
Qty: 4 Ref: 13-9 Schedule 13-9: Temporary Information	
Qty: 3 Ref: 2702 Start of temporary diversion route	
Qty: 2 Ref: 2702 Start of temporary diversion route	
Qty: 2 Ref: 2702 End of temporary diversion route	
Qty: 2 Ref: 2702 Start of temporary diversion route	
Qty: 3 Ref: 2703 Direction of temporary diversion route from junction ahead	
Qty: 3 Ref: 2703 Direction of temporary diversion route from junction ahead	
Qty: 46 Ref: 2703 Direction of temporary diversion route from junction ahead	
Qty: 3 Ref: 2704 Direction of temporary diversion route	
Qty: 3 Ref: 2704 Direction of temporary diversion route	
Qty: 1 Ref: 573 Direction to hazard right	
Qty: 1 Ref: 573 Direction to hazard left	
Qty: 2 Ref: 7010-FP-13-9 Nature of temporary hazard ahead - Road Closed	
Qty: 3 Ref: 7010-FP-13-9 Nature of temporary hazard ahead - Road Ahead Closed	
Qty: 2 Ref: 7010-1 Nature of temporary hazard ahead - Road Ahead Closed	

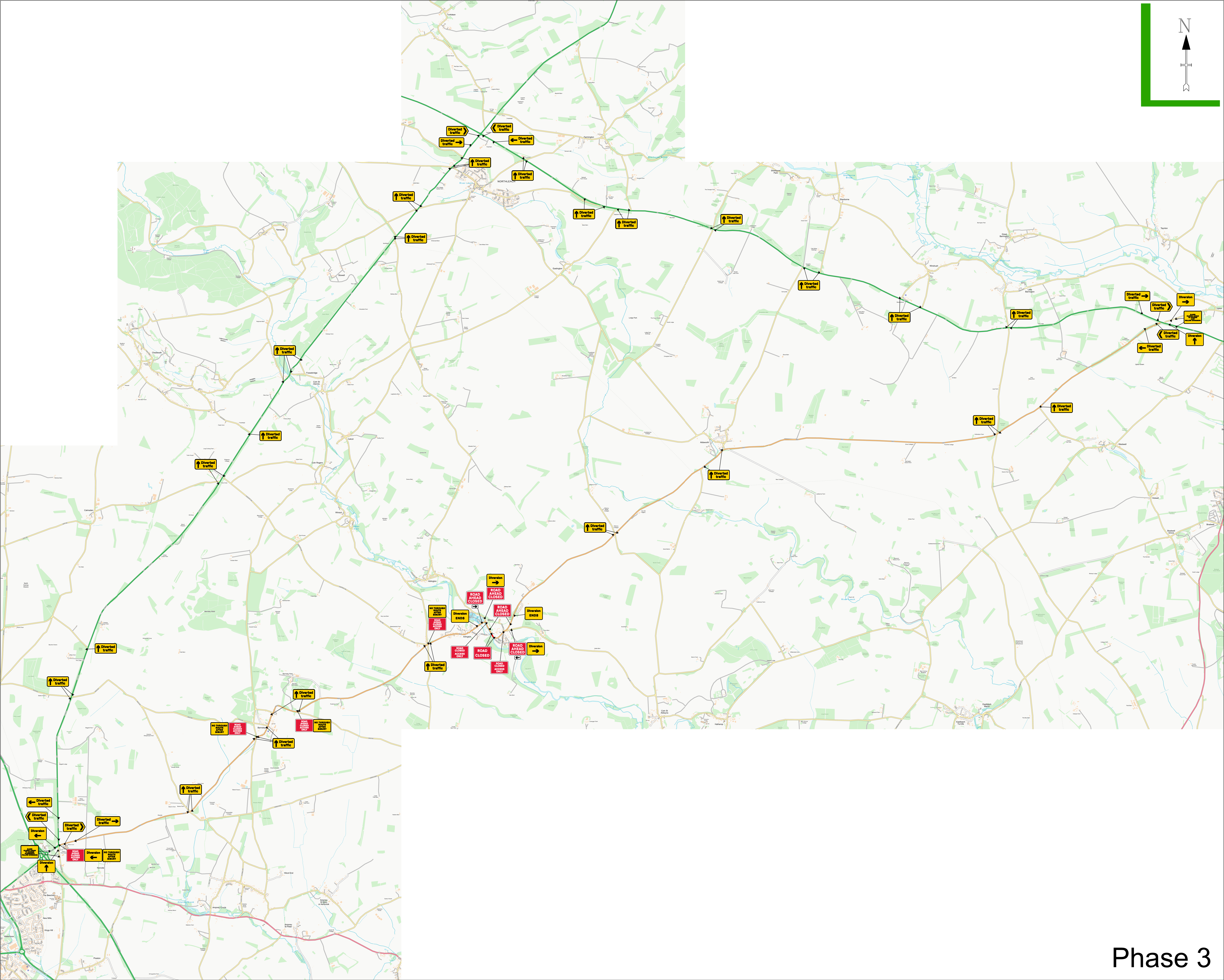
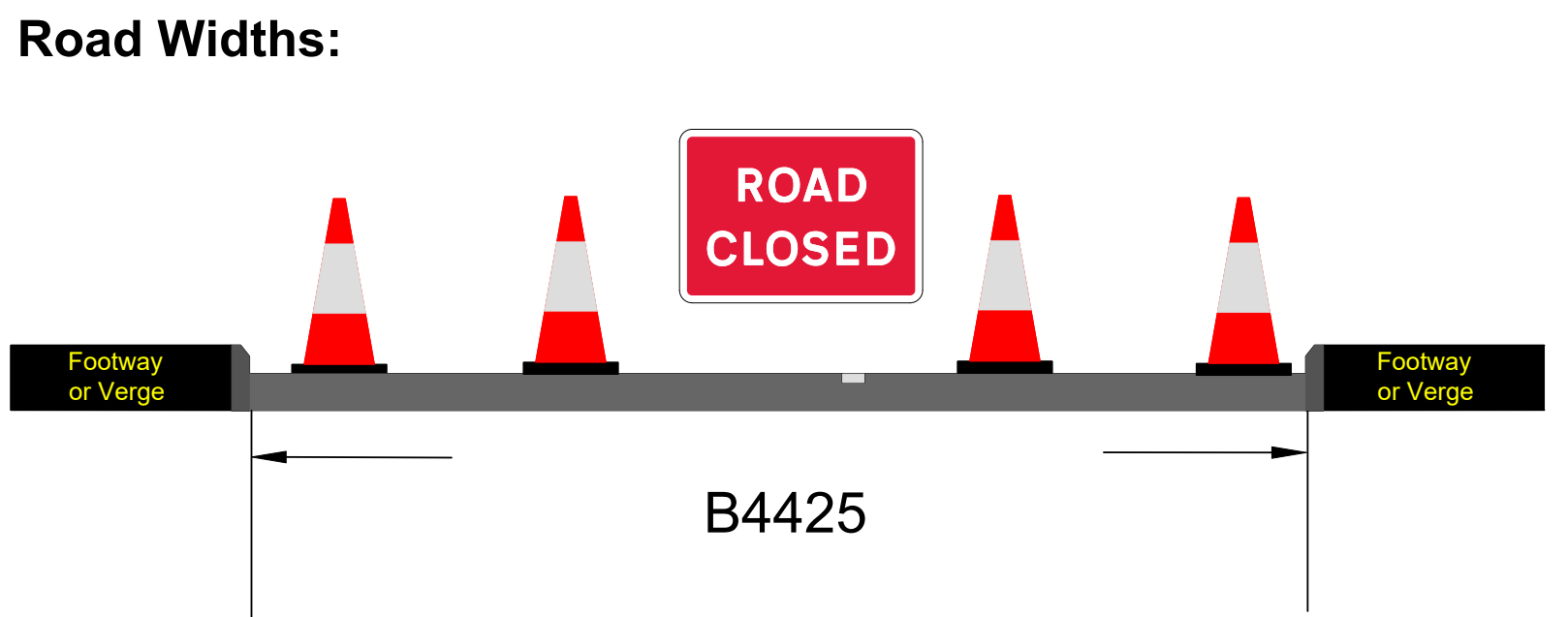

KEY:				
	SAFETY ZONE		CONE	
	WORK AREA		PED BARRIER	
	SPOIL AREA		NO PARKING CONE	









DETAILS OF THE ROAD
B4425

Drawn By	M Oprescu	Traffic Management	Road Closure
Checked By	M Tataru	Road Name	B4425
Survey By	Client	Borough/Council	Gloucestershire County
Date Drawn	15/04/2025	Postcode	GL7 5NS
Drawing No	K9791		

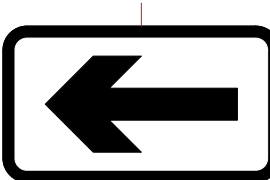

NOTES:

1. All signs and cones to be in accordance with Chapter 8-2009, the TSRGD and current IAN's.
2. Works access and egress are indicative, exact locations to be agreed on site.
3. Safety zones are to be installed as required.
4. All signs to be located so as not to obscure signs or objects and should be ballasted near to ground level using sand filled hessian bags or sign straps.
5. All sign positions are indicative only and must be accurately positioned on site with good visibility and be clear of and obstructions or vegetation at all times.
6. Drawing not to scale
7. TM will comply with the Safety at Street Works and Road Works Code of Practice

Qty: 1 Ref: 2702 Start of temporary diversion route	
Qty: 1 Ref: 517 Road narrows on one side only ahead - right	
Qty: 1 Ref: 517 Road narrows on one side only ahead - left	
Qty: 1 Ref: 573 Direction to hazard left	
Qty: 1 Ref: 613 No left turn	
Qty: 1 Ref: 645 End panel	
Qty: 3 Ref: 7001 Road works ahead	
Qty: 1 Ref: 7010-FP-13-9 Nature of temporary hazard ahead - Road Ahead Closed	
Qty: 2 Ref: 7010-FP-13-9 Nature of temporary hazard ahead - Road Closed	
Qty: 1 Ref: 7010.1 Nature of temporary hazard ahead - Road Ahead Closed	



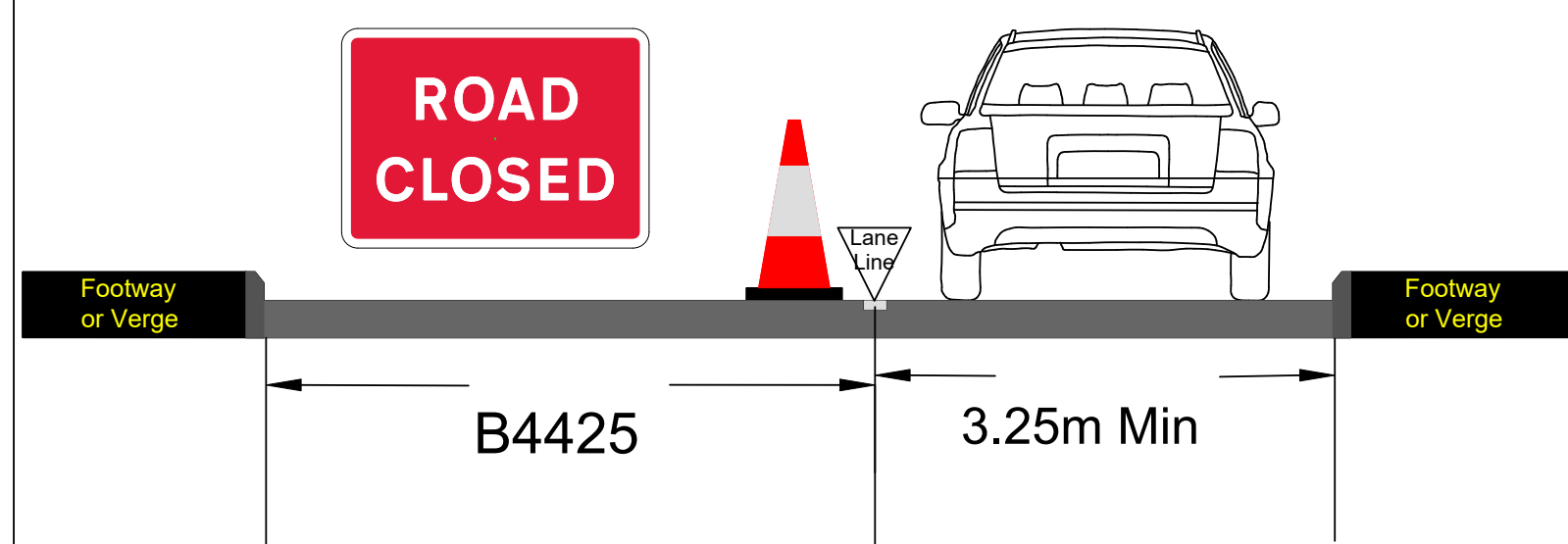



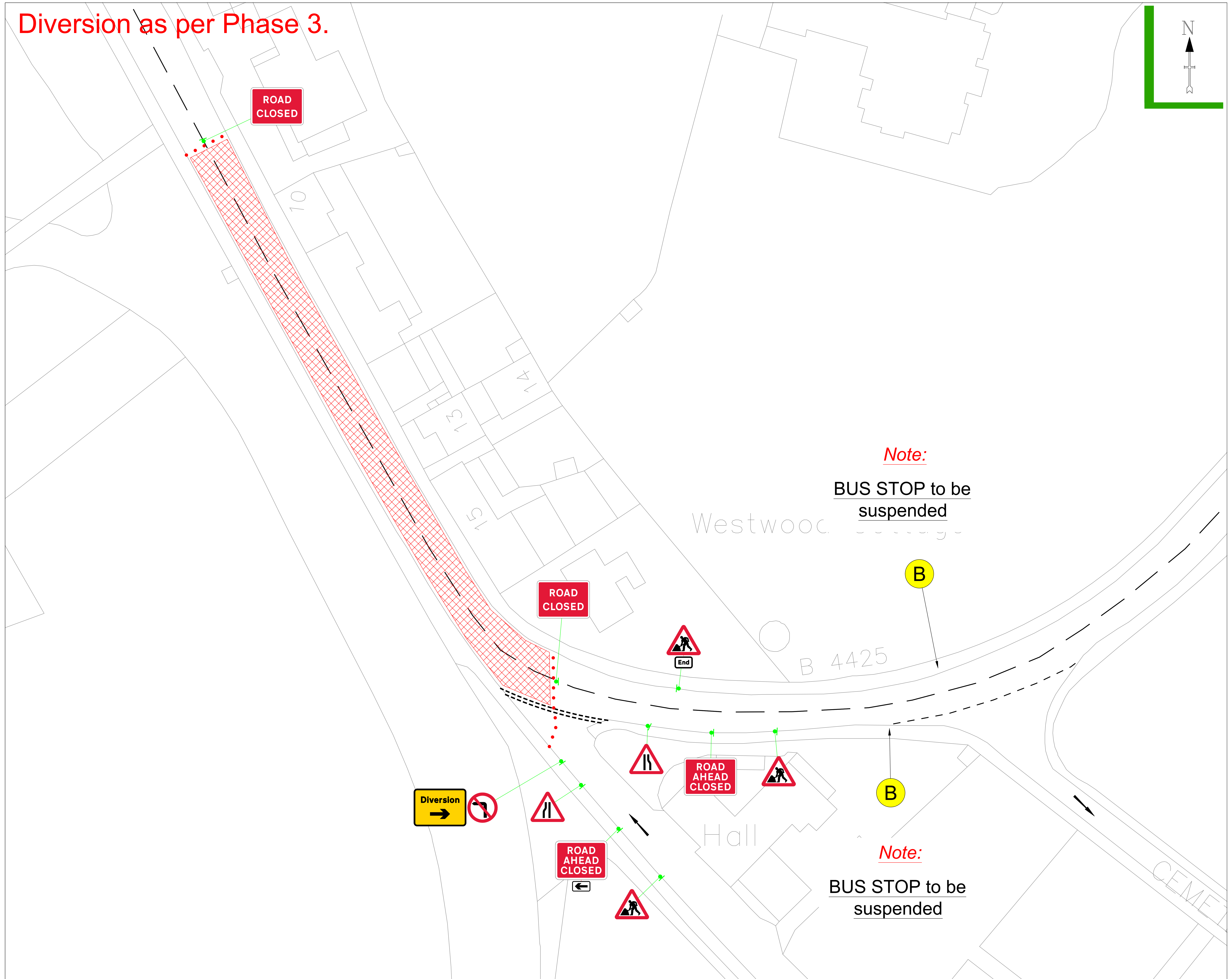

Road Widths:



Diversion as per Phase 3.



KEY:

	SAFETY ZONE		CONE	 Bus stop suspension
	WORK AREA		PED BARRIER	 Parking Bay suspension
	SPOIL AREA		NO PARKING CONE	

	DETAILS OF THE ROAD
	B4425

Drawn By	M Oprescu	Traffic Management	Road Closure
Checked By	R Asauanu	Road Name	B4425
Survey By	Client	Borough/Council	Gloucestershire County
Date Drawn	10/06/2025	Postcode	GL7 5NS
Drawing No	K10101		